



**PARKLEYS, RICHMOND, TW10**  
£2,200 per month\*

**Carter Jonas**



# MARLOWE COURT, PARKLEYS, RICHMOND, TW10 5LR

Nestled in a conservation area near the open spaces of Ham Common with traditional village pond, pub and cricket square. Near local shops, deli, coffee shops on Ham Parade and buses to Richmond and Kingston.

## THE PROPERTY

Stylishly refurbished throughout this first floor flat is situated facing a leafy south facing courtyard garden in this iconic mid-century development. Parkleys is a London Borough of Richmond upon Thames Conservation Area (No.67) and is Grade II listed by English Heritage.

Entrance hall with storage cupboard. Bright and spacious lounge leading through to a further reception/dining room overlooking courtyard garden and leading to a modern kitchen with appliances to include washing machine, slim-line dishwasher, fridge freezer, fan oven and dual function fan-oven/ microwave. Principle bedroom with two built-in wardrobes and further single bedroom with one built-in wardrobe. Modern bathroom with shower over bath.

The property is surrounded by landscaped gardens with a courtyard style garden plus lawned areas and mature trees to the rear.

Available from 24th March part furnished.

Council Tax - D

Holding deposit (one weeks rent) = £507.69

Security deposit (five weeks rent) = £2538.45

## OUTSIDE

In addition to off street parking, there are off street parking bays for residents including some close to this apartment.





**ADDITIONAL INFORMATION**

Offers	Available for six months only
Viewing	Strictly by appointment
Local Authority	Richmond Borough Council - Council Tax Band D
EPC	E

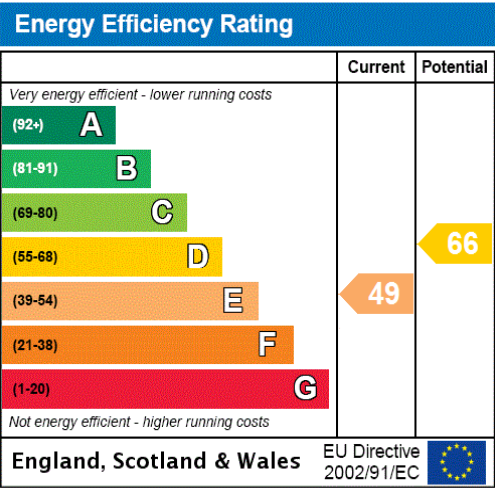





## Marlowe Court, Parkleys, Richmond, TW10

Approximate Area = 774 sq ft / 71.9 sq m  
For identification only - Not to scale

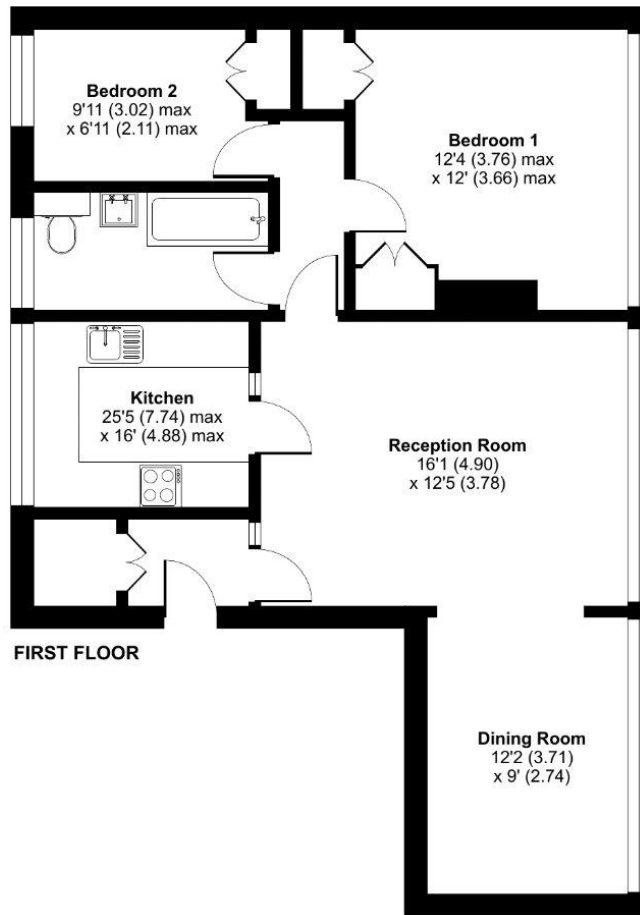

Floor plan produced in accordance with RICS Property Measurement 2nd Edition, Incorporating International Property Measurement Standards (IPMS2 Residential). © nichcom 2025. Produced for Acres And West LTD (Mervyn Smith Estate Agents). REF: 1243686



**T: 020 8878 1115**

70 White Hart Lane, Barnes, SW13 0PZ

E: [barnes@carterjonas.co.uk](mailto:barnes@carterjonas.co.uk)

A member of



*Exclusive UK affiliate of*

**CHRISTIE'S**  
INTERNATIONAL REAL ESTATE

Classification L2 - Business Data

### IMPORTANT INFORMATION

These particulars are for general information purposes only and do not represent an offer or contract or part of one. Carter Jonas or anyone in their employment has made every attempt to ensure that the particulars and other information provided are as accurate as possible and they are not intended to amount to advice on which you should rely as being factually accurate. Full information which may be relevant to your decision regarding the property can be found on the property listing on [carterjonas.co.uk](http://carterjonas.co.uk) or a separately available material information sheet, and we would advise you to confirm the details of any material information prior to any offer being submitted. You should not assume that the property has all necessary planning, building regulations or other consents and Carter Jonas has not tested any services, facilities, or equipment. Any measurements and distances given are approximate only. Where Carter Jonas has been provided with a floorplan by a third party, we cannot guarantee that the floorplan has been measured in accordance with IPMS. Purchasers or prospective tenants must satisfy themselves of all of the aforementioned by independent inspection or otherwise. Our images only represent part of the property as it appeared at the time they were taken and do not represent the furnishings included; these are confirmed in a separate inventory. If you require further information, please contact us. \*Administration fees may apply depending on tenancy type. Please contact your local branch for this information.