



WIMBLEDON GROUNDS, LONDON, SW17

Carter Jonas

WIMBLEDON GROUNDS, LONDON, SW17

THREE BEDROOM FLATS STARTING FROM £2,800 PER MONTH WITHIN THE MODERN WIMBLEDON GROUNDS DEVELOPMENT

NB: Please note photographs may not relate to marketed apartment.

A variety of excellent three-bedroom and two-bathroom flats within Wimbledon Grounds, this prestigious development next to the AFC Wimbledon Stadium. The apartments all have generous balconies, lift access, secure bike storage and landscaped communal gardens. Parking subject to an additional cost and availability.

Transport:

Haydons Road (to Blackfriars) 10 mins walk
Earlsfield (to Waterloo) 15/16 mins walk
Wimbledon Park (District Line) 20 mins walk
Tooting Broadway (Northern Line) 20 mins walk

Minimum term: 12 months

Local Authority: London Borough of Merton

Council Tax: Band D

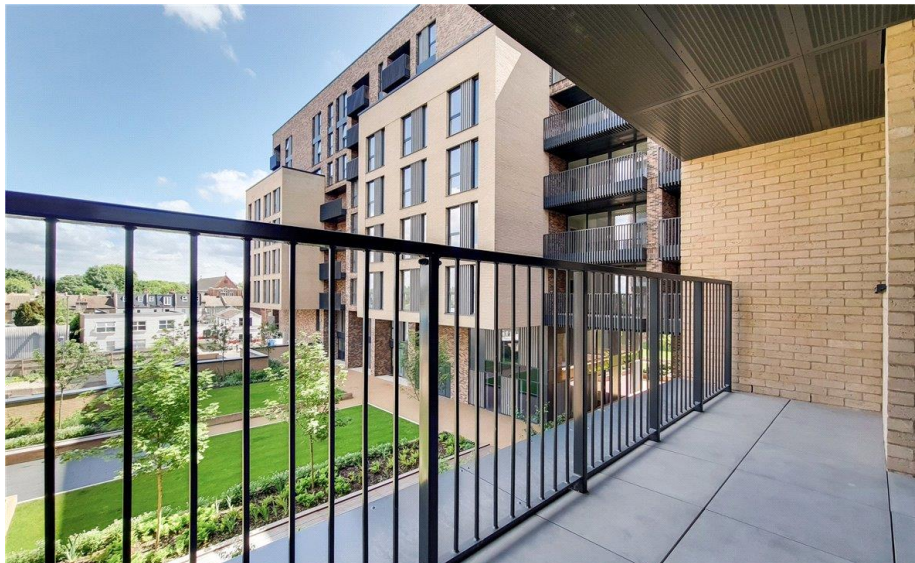

Wandsworth Lettings 020 8682 3121

wandsworth-residentiallettings@carterjonas.co.uk
19 Bellevue Road, London, SW17 7EG



Exclusive UK affiliate of

CHRISTIE'S
INTERNATIONAL REAL ESTATE

Classification L2 - Business Data

IMPORTANT INFORMATION

These particulars are for general information purposes only and do not represent an offer or contract or part of one. Carter Jonas or anyone in their employment has made every attempt to ensure that the particulars and other information provided are as accurate as possible and they are not intended to amount to advice on which you should rely as being factually accurate. Full information which may be relevant to your decision regarding the property can be found on the property listing on carterjonas.co.uk or a separately available material information sheet, and we would advise you to confirm the details of any material information prior to any offer being submitted. You should not assume that the property has all necessary planning, building regulations or other consents and Carter Jonas has not tested any services, facilities, or equipment. Any measurements and distances given are approximate only. Where Carter Jonas has been provided with a floorplan by a third party, we cannot guarantee that the floorplan has been measured in accordance with IPMS. Purchasers or prospective tenants must satisfy themselves of all of the aforementioned by independent inspection or otherwise. Our images only represent part of the property as it appeared at the time they were taken and do not represent the furnishings included; these are confirmed in a separate inventory. If you require further information, please contact us. *Administration fees may apply depending on tenancy type. Please contact your local branch for this information.